

Don't let a small puncture stop a great trip.

Sealing punctures
with advanced
ContiSeal™ technology.

- › ContiSeal™ reduces the consequences of tyre tread damage: punctures up to 5 mm in diameter (e.g. nail damage) are sealed immediately thanks to a unique technology
- › Constant mobility and unaltered mileage - no need for an immediate stop or roadside tyre change (see technical instructions on the back page)
- › Unrestricted driving performance identical to that of a tyre without ContiSeal™ technology under normal operation



The serial tyre which seals itself.

Technical highlights.

ContiSeal™ is a technology developed by Continental designed to seal a damaged tyre tread. In case of penetration by foreign objects such as nails, there is no need for immediate roadside tyre changes, and holes remain sealed even if the puncturing object becomes dislodged.

ContiSeal™ is a sticky, viscous sealant layer. It is applied to the inside of the tyre in the tread area. ContiSeal™ seals 80% of all tyre punctures and therefore reduces the risk of flat tyres. ContiSeal™ tyres are marked clearly with a symbol on the sidewall and are compatible with all commonly available rims.

The ContiSeal™ principle.

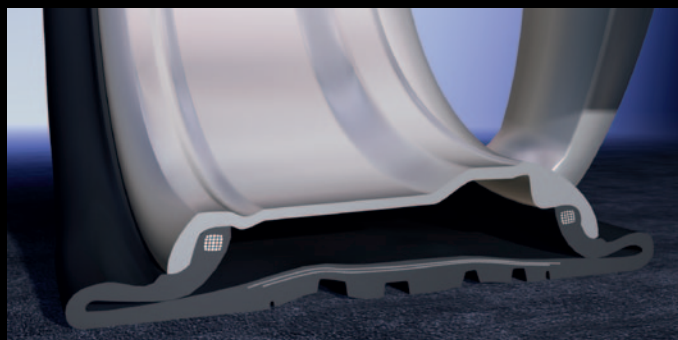

Standard Tyre (Deflated)

When a puncture occurs on a standard tyre, the sidewall can get crushed between the rim and the road, leading to a potentially dangerous situation such as a blowout or the tyre slipping off the rim.

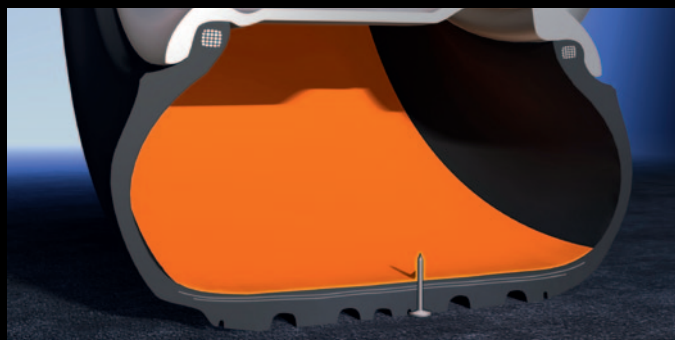

ContiSeal™ (Punctured)

A ContiSeal™ tyre contains a sticky, viscous sealant layer that covers the inside of the tyre tread. It provides an almost instantaneous seal around any penetrating object (up to 5 mm in diameter in the tread area), trapping the air inside and keeping the tyre inflated and your car mobile.

Technical instructions:

- › For optimal conditions, a Tyre Pressure Monitoring System (TPMS) is recommended.
- › It is not necessary to stop immediately for a tyre change. Your journey can be continued.
- › Upon discovering a puncture, a tyre specialist must promptly check the tyre.

Tyre dimensions.

Summer

Tyre width in mm	Tyre cross section	Rim size in inches	Load index	Speed symbol
205-285	Series 35-60	16-21	91-105	H/V/W/Y

Examples of vehicles with original equipment: **Volkswagen** CC/Passat/Passat Alltrack, **Seat** Alhambra, **Rolls-Royce** Ghost/Wraith

Winter

Tyre width in mm	Tyre cross section	Rim size in inches	Load index	Speed symbol
205-235	Series 45-60	16-17	91-99	H

Examples of vehicles with original equipment if a car with winter tyres is chosen: **Volkswagen** CC/Passat/Passat Alltrack/Sharan, **Seat** Alhambra